

THIS DRAWING IS SUBJECT TO FULL VERIFICATION BY MEASUREMENT AND STRUCTURAL SURVEY, UNDERWRITING DESIGN, CONSULTATION OF BODILINESS, EXPERTS AND CONTRACTORS.  
 THIS DRAWING IS SUBJECT TO FULL CONSULTATION WITH STATUTORY BODIES AND ASSOCIATED  
 CONSULTANTS.  
 THIS DRAWING IS SUBJECT TO A FULL ACCESSIBILITY AUDIT AND SENSITIVE DESIGN REVIEW.  
 THIS EXERCISE HAS NOT INCLUDED THE FACILITY OF UNIVERSAL ACCESS OR ASSOCIATED  
 MEASURES.  
 THE DRAWING IS FOR INFORMATION ONLY AND DOES NOT HAVE ANY LEGAL EFFECT. ANY  
 THE DRAWING SHOULD BE USED AS A GUIDE ONLY. THE DRAWING IS NOT TO BE USED FOR  
 OR REUSE IN ANY OTHER PROJECT WITHOUT THE WRITTEN PERMISSION OF NORR. THE  
 DRAWING IS THE PROPERTY OF NORR AND SHOULD BE KEPT IN CONFIDENCE. ALL RIGHTS  
 RESERVED.

Gordon Street

Stanhope Road

Stanhope Road  
26.8m

Proposed 1200mm link  
access footpath from  
Day Centre fire escape

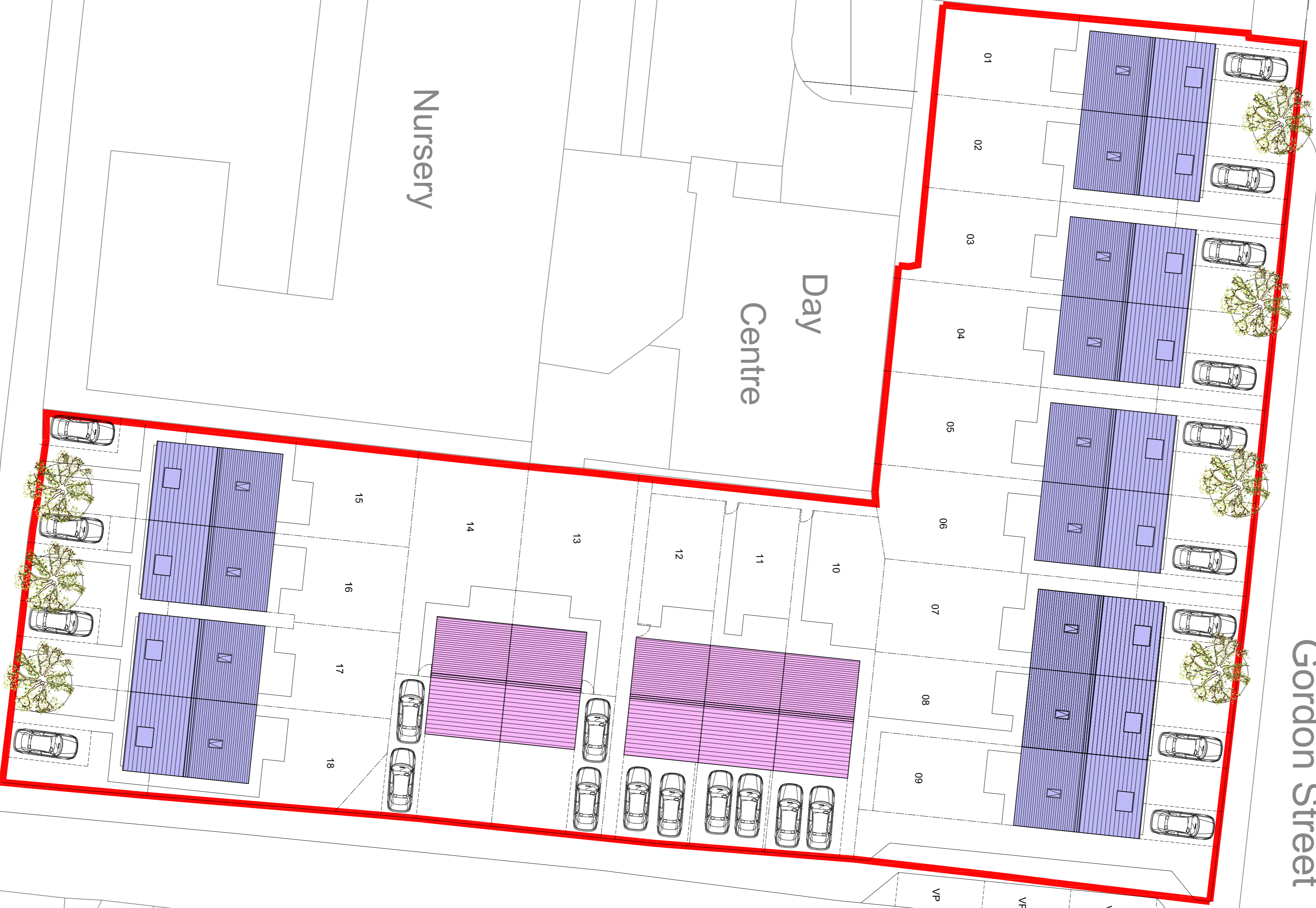

<b>Total 18no. Units</b>	
5no. 2 Bed Semi / Terrace Units	
13no. 3 Bed 2 1/2 Storey Semi Units	
<b>Plots 10 - 14 Gross Internal Floor Areas</b>	
Ground Floor GIFA	37.4m <sup>2</sup> / 403sqft
First Floor GIFA	35.8m <sup>2</sup> / 385sqft
<b>Total: 73.2m<sup>2</sup> / 788sqft</b>	
<b>Plots 1 - 9 &amp; 15 - 18 Gross Internal Floor Areas</b>	
Ground Floor GIFA	34m <sup>2</sup> / 366sqft
First Floor GIFA	30.5m <sup>2</sup> / 328sqft
Second Floor GIFA	24m <sup>2</sup> / 258sqft
<b>Total: 88.5m<sup>2</sup> / 952sqft</b>	

Resurfacing to Back Lane - 10mm Regulatory Course and  
10mm Surface Course

Note:  
Existing kerbs to Garrick Street to be reused. No radii kerbs  
are required - as per Client Instruction.

Rev.	Date	Details	Drawn	Checked
B	13.06.17	RED LINE ROLLOUT/REVISED PER CLIENT	ME	JJ
A	23.05.17	FIRST ISSUE FOR COMMENT	ME	JJ

**INFORMATION**

Project/Client:  
GORDON HOUSE FOR  
ISOS ON BEHALF OF  
GUS ROBINSON  
DEVELOPMENTS LIMITED

Project No:  
LANC 160068

Drawn By:  
ME

Checked By:  
JJ

Scale:  
1:200 @A1

Drawn By:  
ME

Checked By:  
JJ

Date:  
23.05.17

Date:  
23.05.17

Issued for:  
PURCHASE PLAN

8th Floor, Percy House, Percy Street, Newcastle, NE1 4PW  
 T: +44 (0)191 222 1116 F: +44 (0)191 222 1119  
 WWW.NORR.COM



Nursery

Day  
Centre

2

14

16

26

26a

1

1a

30

28

38

40

15

16

17

18

14

13

12

11

10

07

08

09

VP

VP

VP

01

02

03

04

05

06

07

08

09